



## DAV PUBLIC SCHOOL KHAGAUL

**Grade - ..... Class Code - .....**

School will now be using a New Mobile Application **Snap Homework** to Communicate with Parents.

This app will allow teachers to easily communicate with parents

- Parents will receive classroom updates, homework, worksheets and messages from the teacher through this application
- Parents need to Sign-in only once
- Both Parents are requested to **DOWNLOAD** this **FREE** app on their phones

This application will enhance teacher-parent communication while supporting an e-learning initiative to reduce use of paper:

### Parent / Student registration instruction for New User:

#### New User:

1. Go to Google Play Store / App Store and Search "Snap Homework".
2. Install and open app.
3. Tap on New User.
4. Enter Your Name, Mobile Number & Password.
5. Tap on Create Account.
6. Enter the Verification Code (Received through SMS)
7. Tap on Join Your School at the bottom of the screen.
8. Tap on "Parent"
9. Enter Child Name and **Class Code - ....** and tap on Add Child.
10. Now you will see all classroom updates in 'Activity' Screen.

**For Grade & Class Code / PIN scroll down page...**

#### Snap Support

Ask a question and Snap Support will reply by email within 24 hours. Our support is available from 9am to 8pm seven day a week. Contact us in following ways:

**Phone: +918882221009**

**Whatsapp : +91 8178719393**

(Only Chat support)

**Email: support@snapworks.me**

**NOTE: Parents must enter the Grade cum Class Code as given below:**

| <b>Grade</b>         | <b>Class Code/ PIN</b> |
|----------------------|------------------------|
| <b>Grade LKG NEW</b> | <b>E7KQ6Y</b>          |
| <b>Grade UKG NEW</b> | <b>7DZ853</b>          |
| <b>Grade 1 NEW</b>   | <b>8QZX43</b>          |
| <b>Grade 2 NEW</b>   | <b>3KY2NC</b>          |
| <b>Grade 3 New</b>   | <b>H3V824</b>          |
| <b>Grade 4 New</b>   | <b>Y24F3Z</b>          |
| <b>Grade 5 New</b>   | <b>8SVCGN</b>          |

### Snap Support

Ask a question and Snap Support will reply by email within 24 hours. Our support is available from 9am to 8pm seven day a week. Contact us in following ways:



#### PHONE

+91-8882221009 (India)  
+1 (650) 475-6258 (For US  
and International users only)



#### WHATSAPP

+91 8178719393 (India)  
weekdays - 9am to 7pm  
weekends - 9am to 6pm  
+1 (650) 475-6258 (US)



#### EMAIL

[support@snaphomework.me](mailto:support@snaphomework.me)



#### SKYPE

[snaphw.support](https://www.skype.com/people/snaphw.support)

# Online Classes Planner

## Group- 1 (LKG to Std. - II)

Coordinator : Ms. Shyamli Singh (9304535909)  
Assistance (Technical Staff) : Mr. Prabhakar Kumar (9386301894)

| DAY | 1 <sup>st</sup> Period     | 2 <sup>nd</sup> Period |
|-----|----------------------------|------------------------|
|     | 10:00 AM TO 10:45 AM       | 11:00AM – 11:45 AM     |
| MON | Hindi Activity             | Hindi                  |
| TUE | English Activity           | English                |
| WED | Maths Activity             | Maths                  |
| THU | Hindi Activity             | Hindi Rhymes           |
| FRI | English Activity           | English Rhymes         |
| SAT | G.K./Conversation Activity | G.K./Conversation      |

## Group- 2 ( Std. - III to V)

Coordinator : Ms. Sudha Kumari (9934261826)  
Assistance (Technical Staff) : Ms. Pratiksha Rani (8340575221)

### Std. – III

| DAY | 1 <sup>st</sup> Period | 2 <sup>nd</sup> Period |
|-----|------------------------|------------------------|
|     | 10:00 AM TO 10:45 AM   | 11:00AM – 11:45 AM     |
| MON | Science                | Hindi                  |
| TUE | Naitik Shiksha         | ICT                    |
| WED | Science                | Social Science         |
| THU | Maths                  | Social Science         |
| FRI | English                | Maths                  |
| SAT | English                | Hindi                  |

### Std. – IV

| DAY | 1 <sup>st</sup> Period | 2 <sup>nd</sup> Period |
|-----|------------------------|------------------------|
|     | 10:00 AM TO 10:45 AM   | 11:00AM – 11:45 AM     |
| MON | English                | Maths                  |
| TUE | Science                | Social Science         |
| WED | English                | Maths                  |
| THU | ICT                    | Hindi                  |
| FRI | Science                | Naitik Shiksha         |
| SAT | Social Science         | Hindi                  |

### Std. – V

| DAY | 1 <sup>st</sup> Period | 2 <sup>nd</sup> Period |
|-----|------------------------|------------------------|
|     | 10:00 AM TO 10:45 AM   | 11:00AM – 11:45 AM     |
| MON | Social Science         | English                |
| TUE | Maths                  | Naitik Shiksha         |
| WED | Hindi                  | ICT                    |
| THU | English                | Science                |
| FRI | Social Science         | Hindi                  |
| SAT | Maths                  | Science                |

**Please see How to join Virtual Classes on SnapWorks App.  
For Mobile Users (By Using SnapWorks App)**

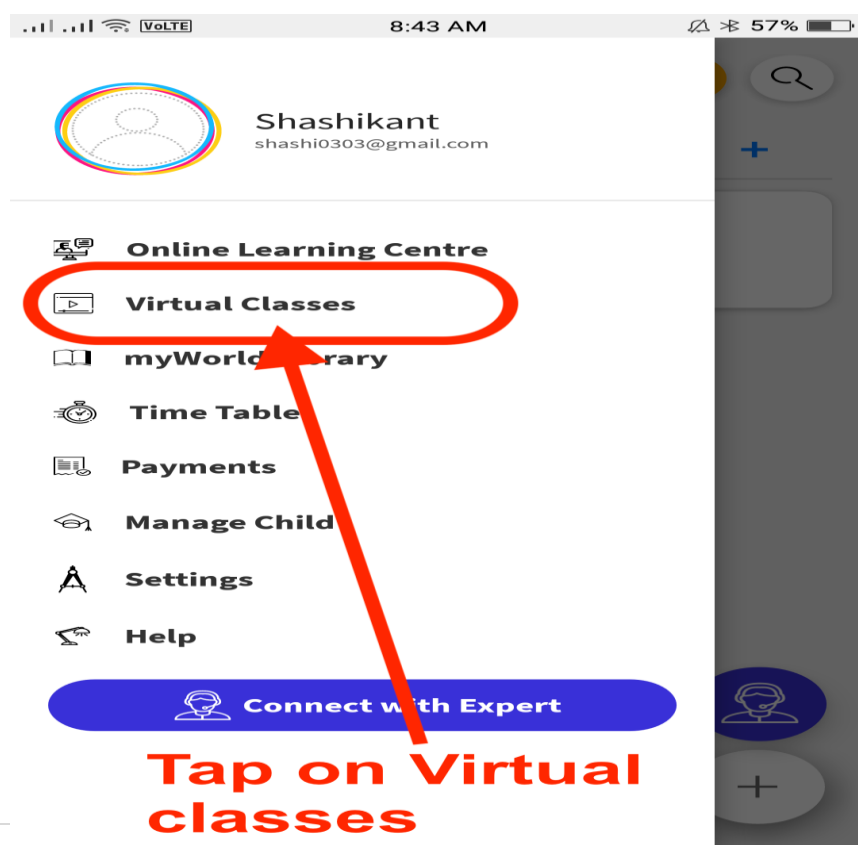
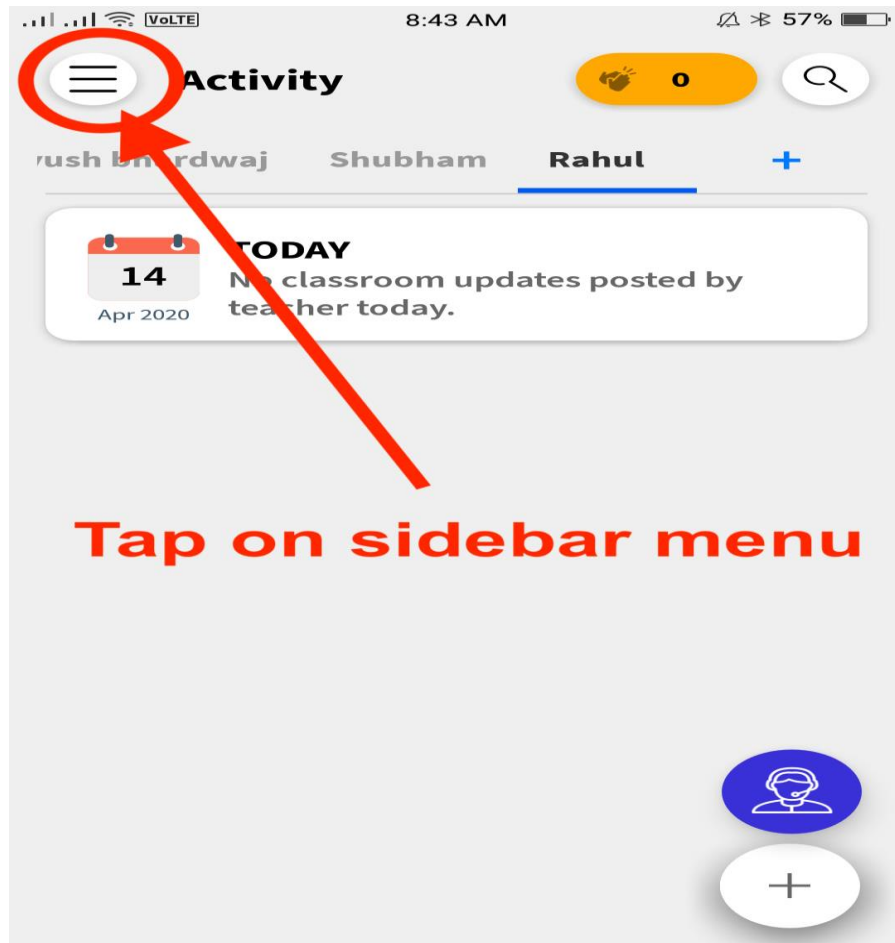

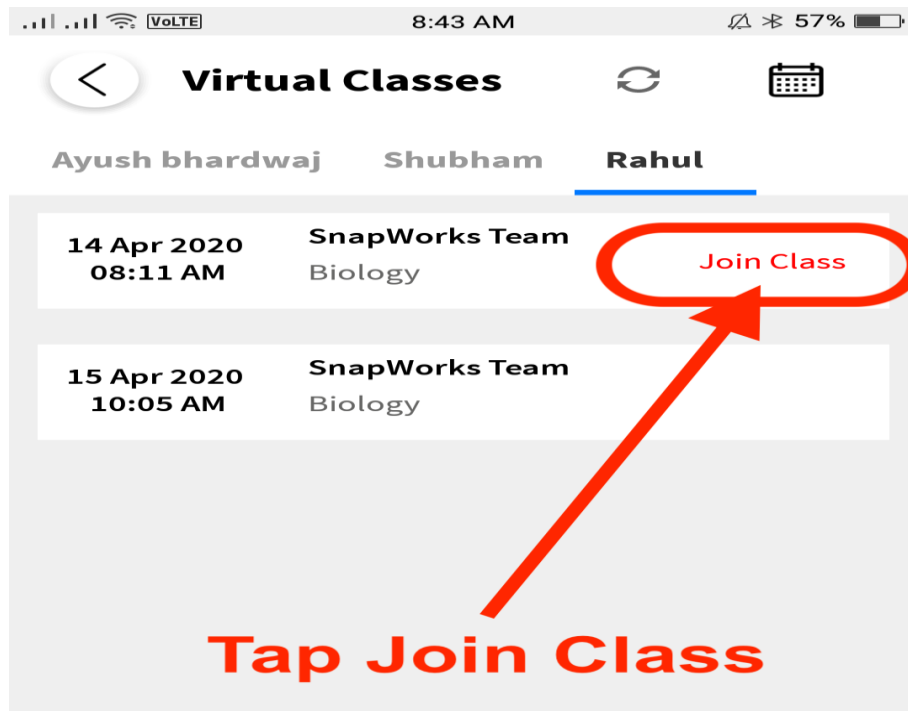

For PC (i.e. Laptop/Desktop) Users  
(By Using Web Browser)

In address bar type [web.snapworks.me](http://web.snapworks.me)



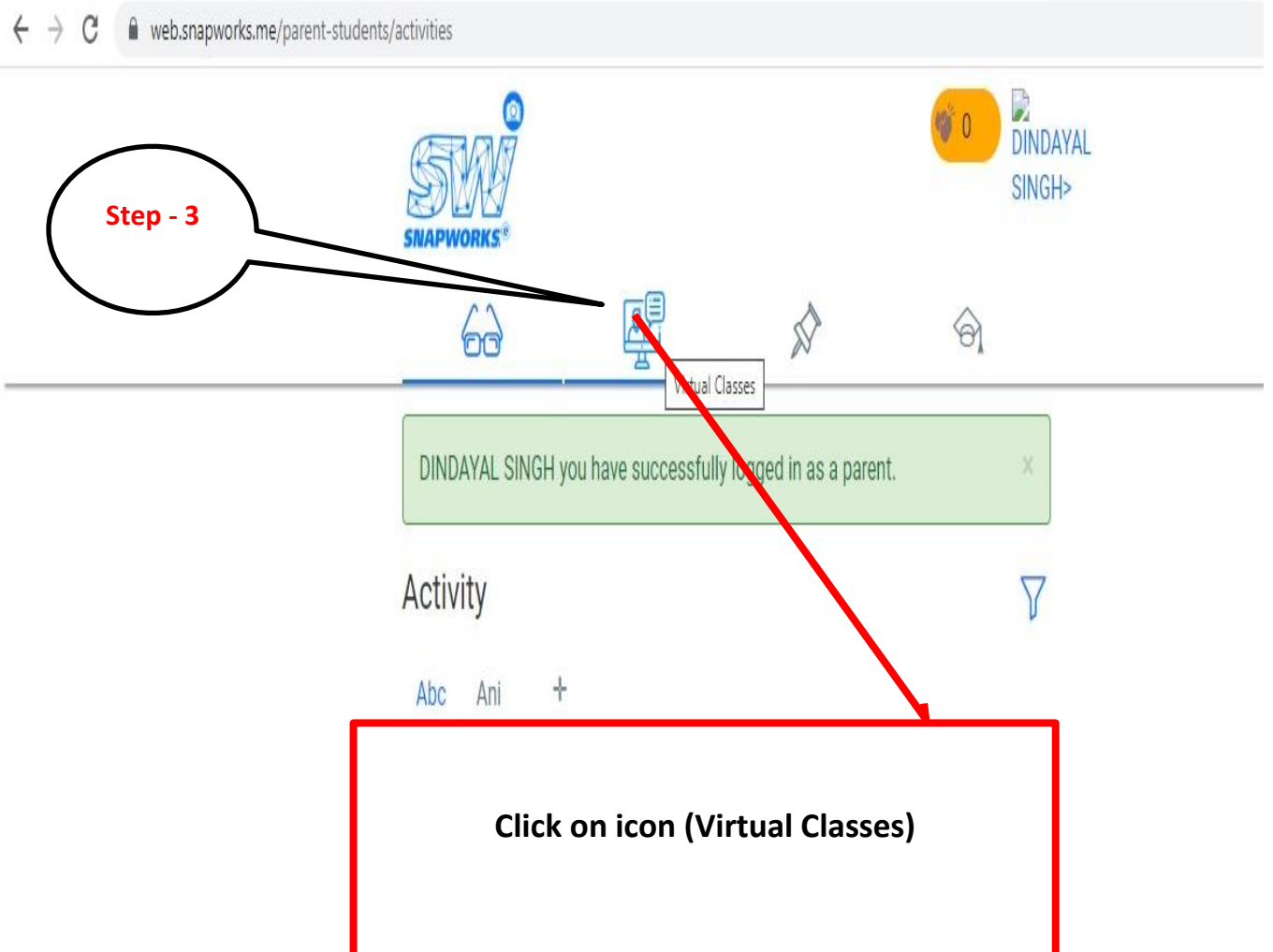
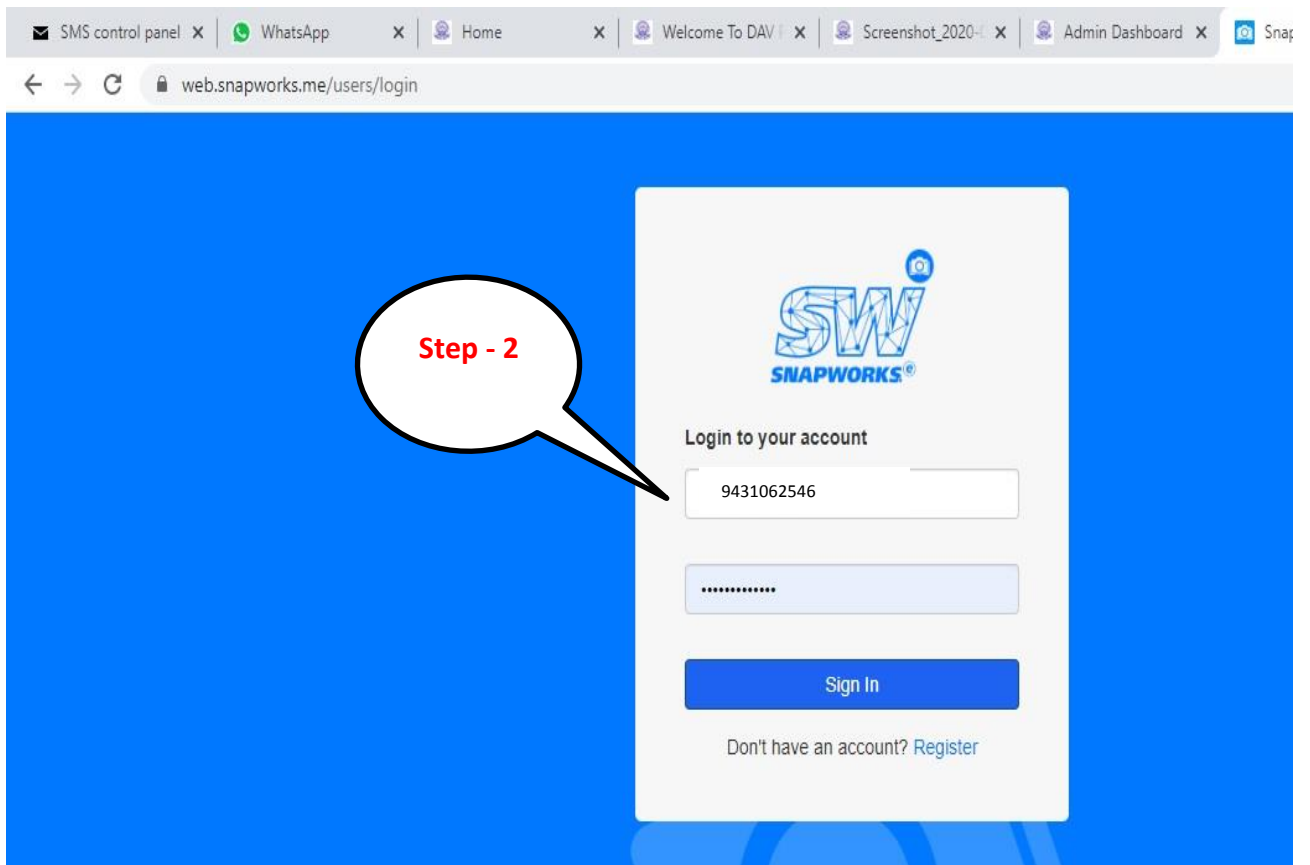



## Virtual Classes

Abc Ani

Friday, 31 July 2020

10:00 AM DAV KHGL ONLINE XI

JOIN CLASS

10:40 AM Math

Zoom

Step - 4

Click on Join Class  
(For Virtual Classes)

## For Any Query/Help Please Contact Us:

### Group- 1 (LKG to Std. - II)

Coordinator : Ms. Shyamli Singh (9304535909)  
Assistance (Technical Staff) : Mr. Prabhakar Kumar (9386301894)

### Group- 2 (Std. - III to V)

Coordinator : Ms. Sudha Kumari (9934261826)  
Assistance (Technical Staff) : Ms. Pratiksha Rani (8340575221)

## Students List (Newly Admitted) of Class – III (Session: 2021-22)

| S. No. | STUDENT NAME               | ADMISSION No. | CLASS | FATHER'S NAME           | MOTHER'S NAME        |
|--------|----------------------------|---------------|-------|-------------------------|----------------------|
| 1      | SHIVAM GANDHI              | <b>23264</b>  | III   | MUKESH KUMAR GANDHI     | PUNAM KUMARI         |
| 2      | ASHWINI RAJ                | <b>23268</b>  | III   | DHARMENDRA KUMAR SINGH  | ANNU KUMARI          |
| 3      | VAIBHAV PRAKASH            | <b>23307</b>  | III   | JAYPRAKASH KUMAR SHARMA | KHUSHBOO SHARMA      |
| 4      | RAJNANDNI JHA              | <b>23308</b>  | III   | PANKAJ KUMAR JHA        | MRIDULA JHA          |
| 5      | HIMANSHU KUMAR             | <b>23334</b>  | III   | HIMANSHU KUMAR          | PUNAM DEVI           |
| 6      | HARSHVARDHAN SINGH SISODIA | <b>23345</b>  | III   | CHANDRASHEKHAR SINGH    | ANJALI SINGH         |
| 7      | SAMAR RAJ                  | <b>23346</b>  | III   | DR SHIV KUMAR GUPTA     | RAJANI KUMARI        |
| 8      | TEJASH KUMAR               | <b>23353</b>  | III   | ASHUTOSH KUMAR          | ANITA DEVI           |
| 9      | ARNAV PATEL                | <b>23359</b>  | III   | DHIRENDRA KUMAR         | ANURADHA KUMARI SING |
| 10     | KRITAGYA KUMAR             | <b>23362</b>  | III   | INDRAJIT KUMAR          | MEENA KUMARI         |
| 11     | AKSH SRIVASTAVA            | <b>23372</b>  | III   | ANJANA SINHA            | ANJANA SINHA         |
| 12     | AKANKSHA PRIYA             | <b>23373</b>  | III   | PATAN KUMAR             | SUNITA DEVI          |
| 13     | NAVYA SINHA                | <b>23388</b>  | III   | SUJIT KUMAR SINHA       | NISHA KUMARI SINHA   |
| 14     | MAYANK KUMAR               | <b>23391</b>  | III   | MANOJ KUMAR RAI         | BABI KUMARI RAI      |
| 15     | ADARSH RAJ                 | <b>23401</b>  | III   | AJIT KUMAR              | SAVITA DEVI          |
| 16     | GIRISH KUMAR               | <b>23415</b>  | III   | SHAMBHU KUMAR           | DOLLY KUMARI         |
| 17     | KRISHAN MURARI             | <b>23417</b>  | III   | SRIKANT SHARMA          | SHWETA DEVI          |
| 18     | SHREYA KUMARI              | <b>23428</b>  | III   | RAJESH KUMAR PANDEY     | PINKY DEVY           |
| 19     | SHIVAM RAJ                 | <b>23434</b>  | III   | RAVI RANJAN SINGH       | GUNJA DEVI           |
| 20     | ARPITA KUMARI              | <b>23438</b>  | III   | ABINASH KUMAR           | MEERA KUMARI         |
| 21     | AYUSH RANJAN               | <b>23439</b>  | III   | ABINASH KUMAR           | MEERA KUMARI         |
| 22     | NAITIK PATEL               | <b>23444</b>  | III   | DHANESH DEVGAN          | PRITI KUMARI         |
| 23     | VIJAY KUMAR VERMA          | <b>23447</b>  | III   | VIJAY KUMAR VERMA       | SATSHA VERMA         |
| 24     | ABHIRAJ                    | <b>23448</b>  | III   | ASHOK KUMAR             | ARTI SHARMA          |
| 25     | YUVESH                     | <b>23449</b>  | III   | SANTOSH KUMAR           | SWETA SONI           |
| 26     | AYUSH RAJ                  | <b>23452</b>  | III   | RAKESH KUMAR            | NAGWANTI KUMARI      |
| 27     | SHEFALI                    | <b>23460</b>  | III   | SACHIN KUMAR            | BABITA DEVI          |
| 28     | DIVYANSH KUMAR             | <b>23461</b>  | III   | AVINASH KUMAR           | PUNAM KUMARI         |
| 29     | AVNI ARYA                  | <b>23465</b>  | III   | MANISH KUMAR CHOUDHARY  | KHUSHBOO             |
| 30     | VISHAL KUMAR               | <b>23467</b>  | III   | RAJU KUMAR              | RINA KUMARI          |
| 31     | ALOK KUMAR                 | <b>23472</b>  | III   | MADAN MOHAN ROY         | AMRITA DEVI          |
| 32     | SATYAM KUMAR               | <b>23478</b>  | III   | RAJU KUMAR              | KUMARI ANITA         |



|    |                    |              |     |                      |                    |
|----|--------------------|--------------|-----|----------------------|--------------------|
| 33 | SREEJA SHARAN      | <b>23479</b> | III | CHANDRA KETU SHARAN  | RACHNA SHARESTHA   |
| 34 | DIVYANGANA SINHA   | <b>23483</b> | III | PIYUSH SINHA         | SWETA KIRAN SINHA  |
| 35 | AKANKSHA SONI      | <b>23491</b> | III | SUNIL KUMR DAS       | PREMLATA           |
| 36 | HARSH RAJ          | <b>23498</b> | III | JEETENDRA KUMAR SING | KANCHAN KUMARI     |
| 37 | RAM ROUSHAN KUMAR  | <b>23499</b> | III | RAM GULAM SAW        | PUNAM DEVI         |
| 38 | LUCKY RAJ          | <b>23502</b> | III | SHIVASHANT KUMAR     | PURNIMA KUMARI     |
| 39 | HARSHIT            | <b>23508</b> | III | MANISH KUMAR SINGH   | VINEETA DEVI       |
| 40 | ROCKY RANJAN       | <b>23514</b> | III | ARUN KUMAR SINGH     | RITA KUMARI        |
| 41 | SAVYA SHUBHAM      | <b>23515</b> | III | RAJIV KUMAR          | PUJA DEVI          |
| 42 | YUG PRAKASH        | <b>23516</b> | III | ARUN KUMAR           | ALKA SINGH         |
| 43 | PIYUSH RAJ         | <b>23521</b> | III | RANJIT KUMAR         | SONI KUMARI        |
| 44 | AARUHI KUMARI      | <b>23523</b> | III | MARUTIKA JAYGHOSH    | KHUSHBOO SHARMA    |
| 45 | MUHAMMAD OMAR ALAM | <b>23524</b> | III | KHURSHID ALAM        | SHAHINA SHAHI      |
| 46 | ANANYA RANJAN      | <b>23531</b> | III | RAJEEV RANJAN        | KHUSHBOO KUMARI    |
| 47 | DEV SHAINDIYA      | <b>23532</b> | III | SUMAN TIWARI         | RANI DEVI          |
| 48 | ASHI SINHA         | <b>23545</b> | III | AMITESH AMIT         | SONAL VERMA        |
| 49 | ABHISHEK RANJAN    | <b>23546</b> | III | BIMLESH KUMAR        | JULI KUMARI        |
| 50 | PRINCE RAJ         | <b>23553</b> | III | LET RAJ NARAYAN SING | JYOTI KUMARI       |
| 51 | PRATAP BHANU       | <b>23554</b> | III | SANTOSH KUMAR        | REKHA KUMARI SINHA |
| 52 | ANKUSH KUMAR       | <b>23557</b> | III | BHUPENDRAKUMAR SINGH | ANKUSH KUMAR       |
| 53 | DIVYANSH KUMAR     | <b>23568</b> | III | AVINASH KUMAR        | PUNAM KUMARI       |
| 54 | SREEJA SHARAN      | <b>23575</b> | III | CHANDRA KETU SHARAN  | RACHNA SHARESTHA   |
| 55 | PUSHKAR KUMAR      | <b>23588</b> | III | RAKESH KUMAR         | SAPNA KUMARI       |
| 56 | STUTI SHARMA       | <b>23593</b> | III | RAJESH KUMAR         | SHABNAM KUMARI     |
| 57 | APRATIM            | <b>23605</b> | III | ARUN KUMAR AMAR      | PREMLATA           |

**R. Roy**  
**Principal**